



DISCOVERY PIER
13271 S WEST BAY SHORE DRIVE
TRAVERSE CITY, MI 49684



Venue Blue on Discovery Pier

We're so excited to
be a part of your event!

Venue Blue is owned and operated by the Discovery Center & Pier, a non-profit organization. Our mission is to inspire, educate, and connect people of all ages, abilities and needs to the Great Lakes. Your venue rental will help support our barrier-free recreational amenities, educational and recreational programs, and operations.

Venue Manager:
Laura Muzzarelli
Laura@DiscoveryGreatLakes.org
231-299-0106



The Pier

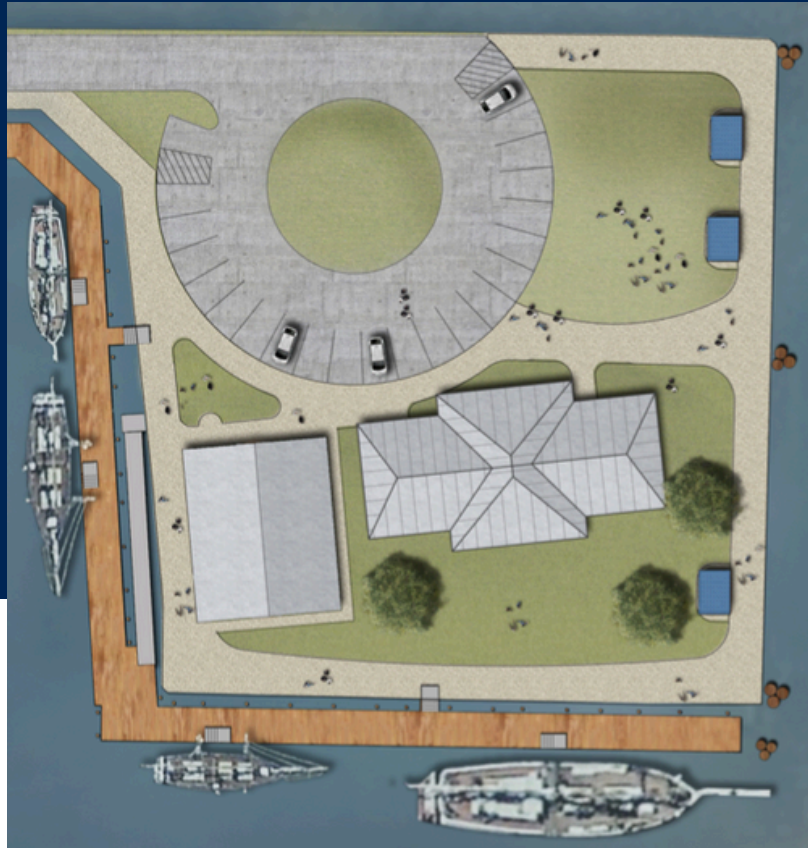

The Discovery Pier Park consists of a 4,000 square-foot pavilion, 4,000+ square-foot courtyard, barrier-free parking and sidewalks, and three fishing area shelters with ADA benches. Surrounding the main pier areas are the docks to the ships owned and operated by our various partners.

The Pavilion



About the venue

- 4,000 square-foot covered pavilion
- Accommodates up to 300 persons
- Universally Accessible
- Permanent overhead lighting
- Permanent overhead heating if needed
- Heavy-duty transparent sides for weather/privacy
- Outlets on every pillar for power needs
- Water access for caterers

Coming in 2027:

- Catering kitchen
- Permanent restrooms
- Dockside Learning Lab

Included in your rental

- On-site venue manager
- Parking and parking attendant
- Staff to maintain restrooms during event
- Option to use 4,000+ square-foot outdoor lawn area
- Use of 11 picnic tables and 5 white folding tables, placed where you choose
- Use of floor planning software
- Use of property for photography (excludes ships)

Pavilion Pricing



May to October

Monday - Thursday

\$1500

Friday or Sunday

\$3000

Saturday

\$4000

Low impact hourly rental (up to 4 hours)*
| Per hour \$150

November to April

Monday - Thursday

\$1000

Friday or Sunday

\$2000

Saturday

\$3000

Low impact hourly rental (up to 4 hours)*
| Per hour \$125

Multi-day events will be considered for a discounted rate

2026 Rates subject to change

Rental rates for Non-Profit events:

Venue Blue will be available at a 25% discount for non-profit organizations. For educational programs held during weekdays, contact the Venue Manager about our Programming Rate.

If you are interested in renting only the lawn area on the pier, please contact the Venue Manager for availability and pricing.

* Low impact event - please contact the Venue Manager if you think your event might fit this criteria (no food permitted)



Sample Layouts

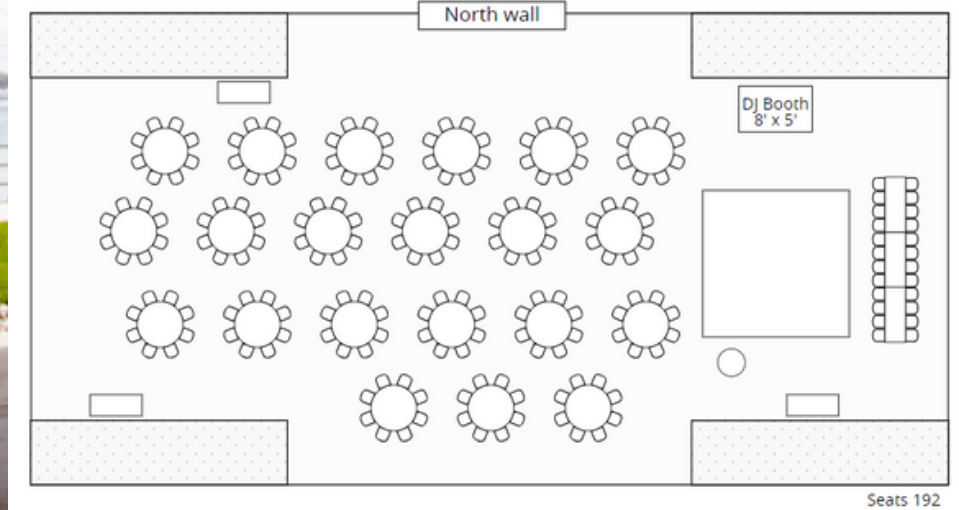
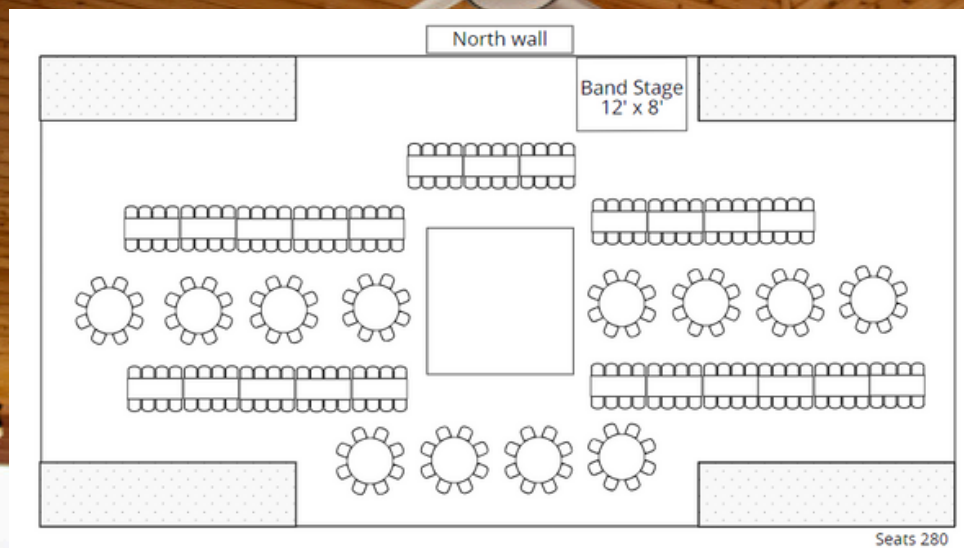
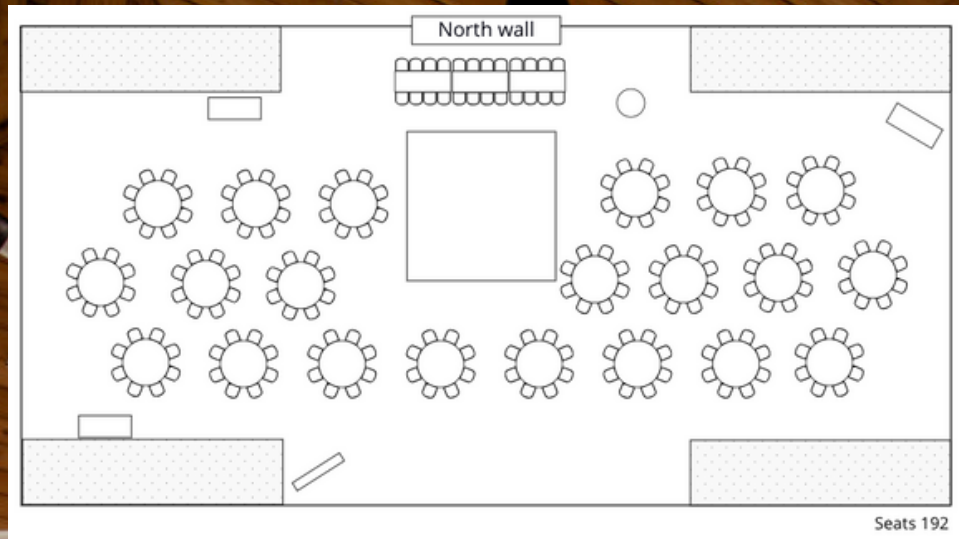

Frequently Asked Questions

- Will the pier be closed to the public during my event?
 - No, due to the Discovery Pier being a public park, it will remain open. We will have signs dedicated to informing the public of the private event taking place. We will also have staff to direct guests and the public.
- Is the venue handicap accessible?
 - Yes! The entire pavilion and Discovery Pier is handicap accessible.
- Are there noise restrictions?
 - Yes, all projected sound has a cut-off time of 10pm per Elmwood Township.
- Can we take pictures on the ships?
 - No. The ships are owned and operated by our partners and are unavailable for use to renters of Venue Blue.
- Are fireworks allowed?
 - No, Elmwood Township prohibits fireworks except on certain dates. See page two of the [Elmwood Charter Township Consumer and Display Fireworks Ordinance](#) for these dates.
- Are candles and/or sparklers allowed?
 - All open flames (candles, etc.) must be contained.
 - Sparklers are allowed, a bucket of sand or water must be present for the extinguishing of said sparklers.
- Are there restrooms on-site?
 - For the 2024 season, we will be provided multiple porta johns, with at least one being ADA compliant. If you wish to rent a separate restroom trailer you may do so.
- Do you provide rentals? (Tables, chairs, etc.)
 - For the 2024 season we will not have any rentals in-house. We will be looking to provide rentals in the next few years.
- Do you have parking?
 - Parking is available free of charge for event guests. Most of our parking is located across the street from the Discovery Pier. We will have staff to guide guests across the street and handle traffic. We recommend that large events utilize outside transportation companies to shuttle their guests.
- Do you have a bridal suite?
 - No, we do not have a bridal suite for bridal parties to get ready.
- Is event insurance required?
 - Yes.
- Is alcohol allowed?
 - Yes. All renters of Venue Blue that wish to serve alcohol must include this in their event insurance.

A site supervisor will be on site the day of your event to help assist you with any venue needs. This person is not responsible for coordinating your event, décor set-up/tear down, or facilitating vendors.